

AN EPITOME OF LUXURIOUS LIFESTYLE



GREEN VILLAS-II

— A HIGHER QUALITY OF LIVING —

Welcome To Reliance Builders

Majid Chanzeb has been a prominent figure in the real estate industry for over 25 years, providing unmatched expertise in the development and construction of top-notch properties across Pakistan.

With his vision and leadership, Reliance Builders has become a household name, renowned for delivering exceptional quality, innovative designs, and unparalleled customer service.

His dedication to excellence and passion for real estate is reflected in every project we undertake.

Majid Chanzeb
Chief Executive Officer





PRIME ARCADE



PARK VIEW PLAZA



GREEN VILLAS



EXECUTIVE ARCADE



CLASSIC CENTER



CITY CENTER 1 & 2



AVENUE ARCADE



RELIANCE ARCADE



RELIANCE GOLD

Our History

Reliance builder is a well-known name in real estate industry in Islamabad. Our focus was to provide unparalleled quality of service, with honesty and integrity. Our focus enabled us to achieve a rapid growth rate and by 2007 we became involved in the construction industry - initially building houses for our local and overseas clients.

Who placed their faith in us? As our team grew and our standard of build quality enhanced our reputation, we began to take on larger projects in conjunction with our associates, partners and investors. Today we are a reputable real estate and construction company specializing in residential and commercial projects of varying sizes with many satisfied clients around the world.



Project Location

Green Villas-II are located in C-18, Green Villas-II are about 10 minutes drive from G-T Road, Motorway Interchange. This zone is considered to be the focus of investment in real estate being closer to the New Islamabad International Airport and connected with Islamabad & Rawalpindi through G.T Road, Srinager Highway.

Specially after the construction of Margala Avenue by CDA, traveling to City Center would be a breeze. D-17 & D-18 connected distance of just 2 km to Islamabad/Peshawar Motorway (M-1) & Srinagar Highway via interchange.

EASY ACCESS TO EVERYWHERE



AIRPORT
15-20 MIN



METRO MASS TRANSIT
15 MIN



MOTORWAY M-1
5 MIN



AWT INTERCHANGE
10 MIN



SERENA HOTEL
35 MIN



CENTAURUS MEGA MALL
30 MIN



ZERO POINT ISLAMABAD
15 MIN



G . T ROAD
5 MIN





Green Villas-II

Green Villas-II are conveniently located in C-18, making it accessible from all directions. You will find everything you need for the ultimate indulgent experience in the comfort of your room, which offers unmatched panoramic views of the captivating Margalla Hills along with the finest finishings and amenities. The villas are a premium lifestyle destination because to its first-rate amenities and superb attention to detail. Find the height of comfort in the serene haven that is unmistakably Green Villas-II.

To improve your standard of living, high-quality materials have been chosen for the doors, windows, and floors. Preserve it from any disaster as much as we can; it is built to withstand earthquakes. We know how to make your dream home a location where you feel comfortable, thus no detail has been overlooked.

Three-bedroom villas with an elegant design to match your preferences and financial constraints are available to you through Green Villas-II.

05 MARLA
— PLOT SIZE: 25X50 —

05 MARLA

PLOT SIZE: 25X50

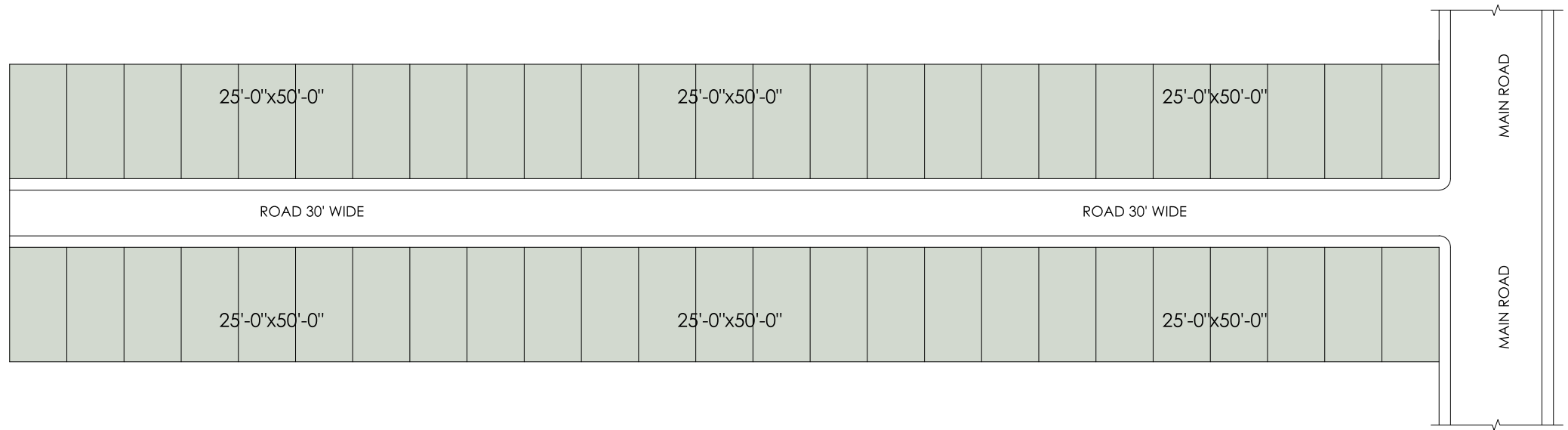



Features

The turn-key house development known as Green Villas-II epitomises affordable luxury. It offers elegantly designed contemporary living in a mix of 3-bedroom villas with first-rate amenities.

Green Villas-II are perfect for busy, small families who want simplicity with a dash of elegance. Our villas include practical spaces for living rooms, cosy bedrooms, American kitchens, baths, and car parking while still being roomy.



Fitted Kitchen



Fitted Wardrobes



High-End Finishes



3 Bedrooms



Security



View



Parking

05 MARLA



PLAN

PLOT SIZE: 25X50
PLOT AREA: 1250 Sq.ft
COVERED AREA: 2,227.45 sqft
BEDROOMS: 3
POWDER ROOM: 1
PARKING SPACE: 1 COVERED



Bedrooms



Security



View



Parking

GROUND FLOOR

ISOMETRIC VIEW

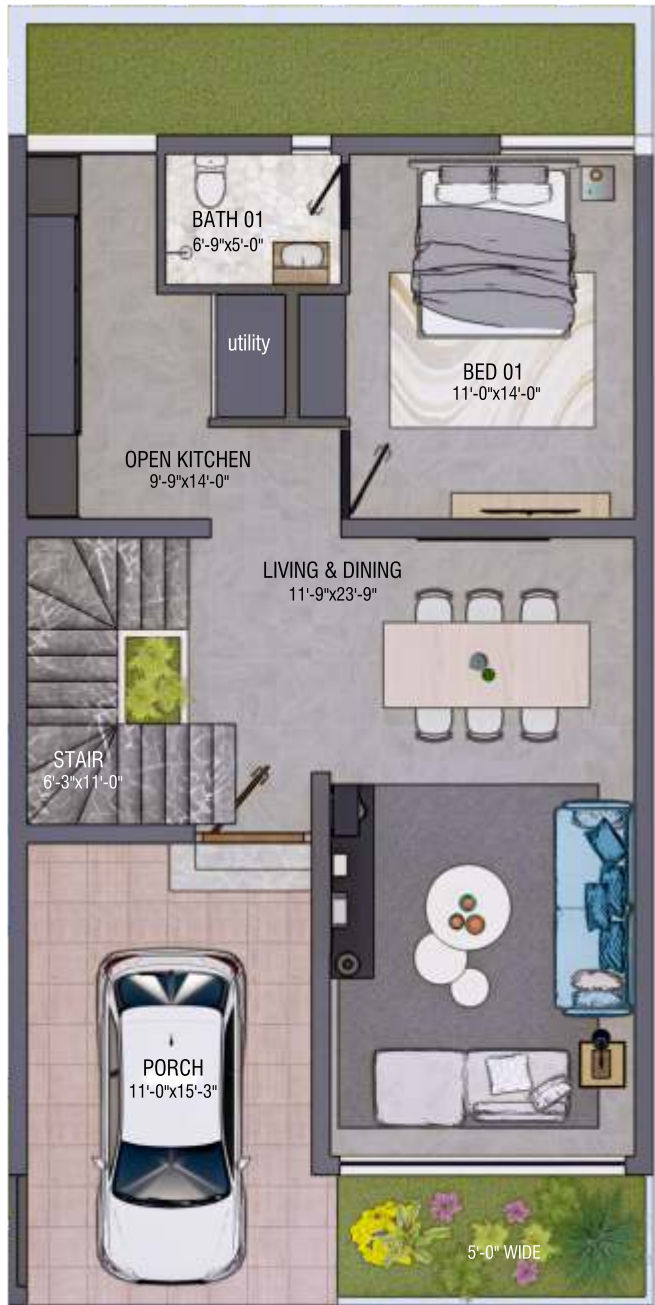

FIRST FLOOR

ISOMETRIC VIEW

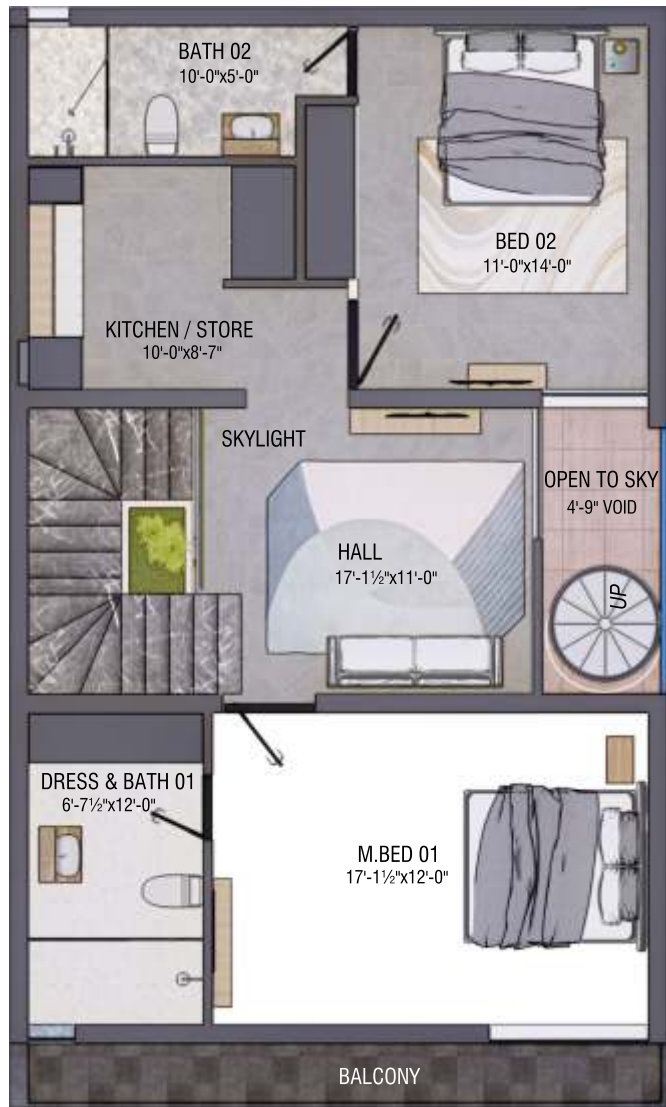

05 MARLA

GROUND FLOOR
ISOMETRIC VIEW



FIRST FLOOR
ISOMETRIC VIEW





LUXURY
IS IN EACH
DETAIL



PREMIUM
FINISHES



QUALITY
LIVING



05 MARLA

— PLOT SIZE: 25X50 —





LUXURIOUS
LIFE IS A
DREAM



IT IS A
LIFESTYLE



LUXURY
IS MADE



AN EPITOME OF LUXURIOUS LIFESTYLE



GREEN VILLAS-II

— A HIGHER QUALITY OF LIVING —

A Project of



Head Office:
Office # 205, 206 2nd Floor, Park View
Plaza, F-10 Markaz, Islamabad.
Ph: 051-4718310-312

Site Office:
M.S.C Margalla View Housing
Scheme D-17/2, Islamabad.
Ph: 051-2229797-98 | Mob: +92-316-1681616

  @reliancebuildersofficial
 www.reliancebuilders.com.pk
 reliance_builders@yahoo.com